



# Blackland Farm Outdoor Centre 2026



## Monday 1st June - Friday 5th June 2026

Please note the residential takes place the week after May half term - not the week before.





# Blackland Farm 2026

Navigation app interface showing a route from Loxwood Primary School to Blackland Farm Outdoor Centre.

**Search along the route** | **Petrol** | **EV charging** | **Hotels**

**Route Options:**

- Best** (52 min, 3h 35m, 10 hr, 2h 43m)
- via M23** (52 min, 31.4 miles) - Fastest route, the usual traffic
- via A264 and M23** (52 min, 32.1 miles)
- via B2110** (53 min, 29.8 miles)

**Map Details:**

- Start: Loxwood Primary School
- End: Blackland Farm Outdoor Centre
- Route: via M23, A264, and B2110
- Distance: 31.4 miles (via M23)
- Time: 52 min (via M23)

**Map Labels:** Frimley, Woking, Farnborough, Aldershot, Guildford, Godalming, Cranleigh, Hindhead, Chiddingfold, Haslemere, Billingshurst, Midhurst, Petworth, Pulborough, Storrington, Arundel, Chichester, Crawley, Horley, Lingfield, East Grinstead, Blackland Farm Outdoor Centre, Ardingly, Haywards Heath, Burgess Hill, Hassocks, Ringmer, Lewes, Falmer, Steyning, Henfield, Uckfield.

**Layers:** South Downs National Park, Surrey Hills National Landscape.

**Address: Blackland Farm Outdoor Centre, Grinstead Lane, East Grinstead, RH19 4HP**





# Blackland Farm 2026

## Drop off and collection

Please drop off and collect from outside Weavers Lodge. You will need to drive past the main office and follow the road until you see the lodge on the left-hand side. It is the second building on the left as you go past the office.

**Arrive: Monday 1st June at 10am**

**Collect: Friday 5th June at 1pm**

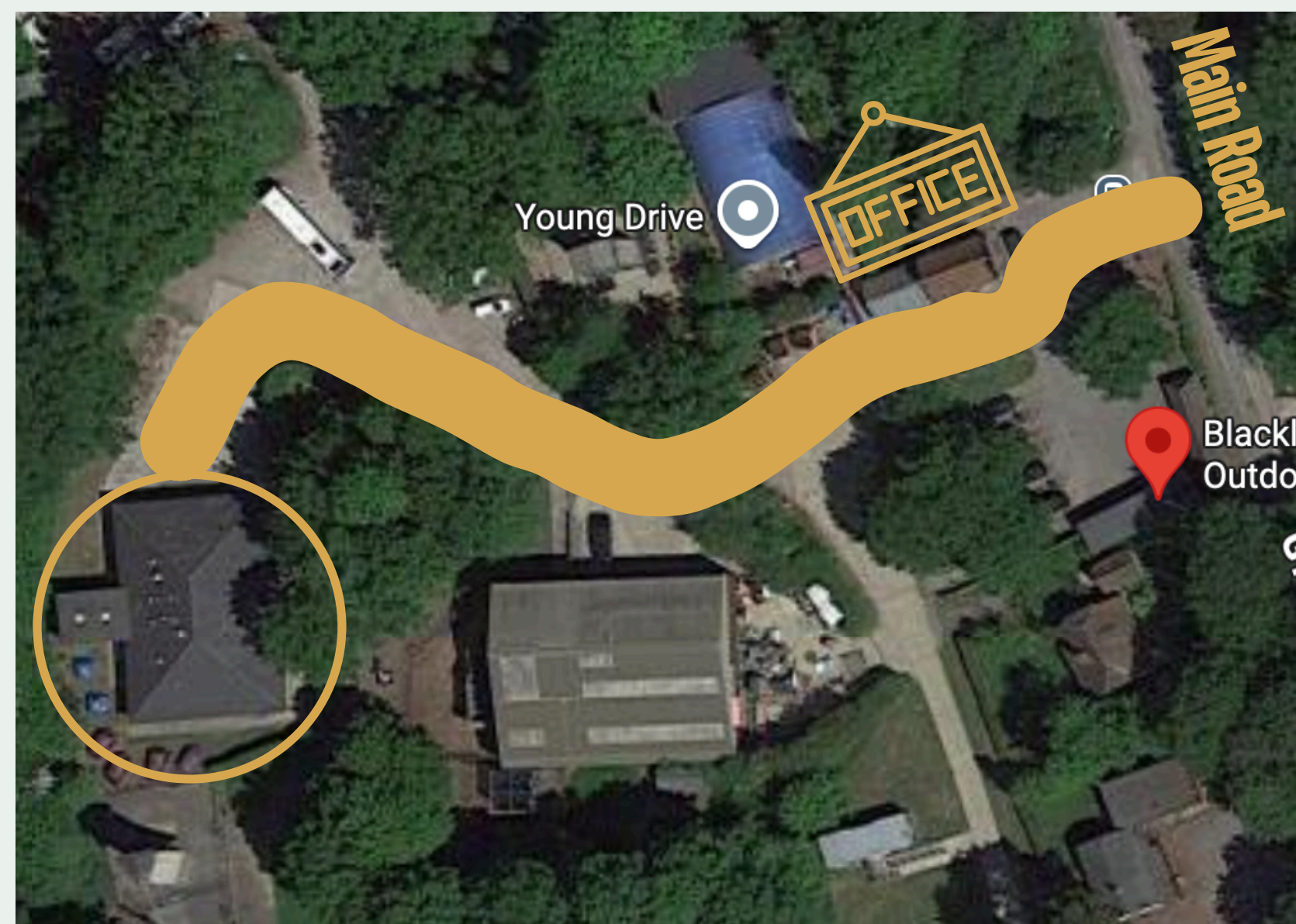
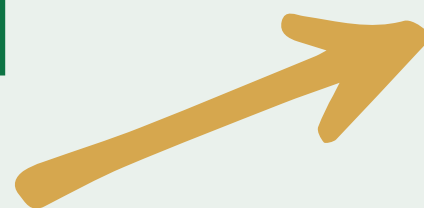



# Blackland Farm 2026

*Who is going?*



*Mrs O'Mara*  
ASSISTANT TEACHER



*Miss Wright*  
CLASSROOM TEACHER



*Miss Price*  
DEPUTY TEACHER



*Mrs Mellors*  
HEADTEACHER

All Blackland Farm Staff are first aid trained.

If you need to reach us, please contact the school office.  
If we need to contact you, you will receive a call from the office.





# Blackland Farm 2026

## Weavers Lodge

- a large hall which is used for dining and evening activities and games.
- a well-equipped kitchen which all three meals are served from
- four dormitories with eight bunk beds in each
- step-free access
- accessible sleeping, toilet and bathroom facilities.







# Blackland Farm 2026

**All bunks come with mattresses, however you will need to provide own bedding (sheet and duvet or sleeping bag), pillow and towel.**

**A kit list will be sent home with the children nearer the time.**

Separate rooms for girls and boys. Children can list 3 friends they'd like to share with. We ensure they are with at least one of their chosen friends – this will be for rooms and activities.





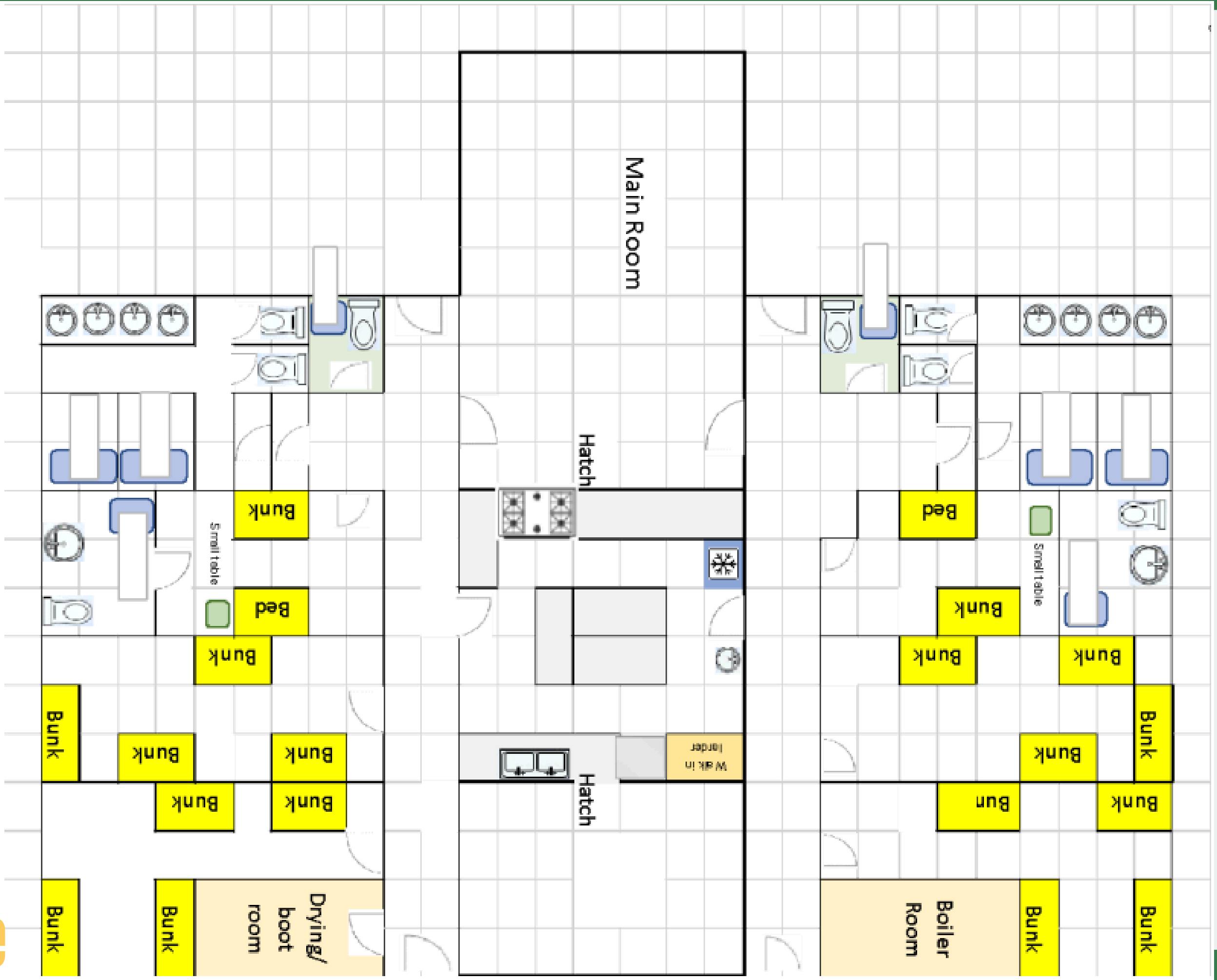
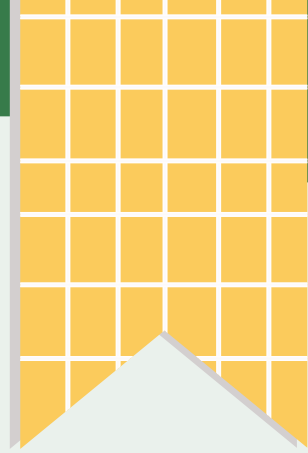

Weavers Lodge



# Blackland Farm 2025





# Blackland Farm 2026



Weavers Lodge



# Blackland Farm 2026

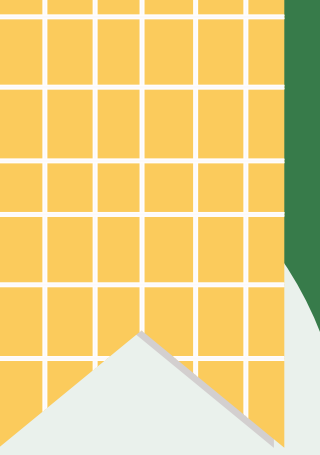

Evening Activities



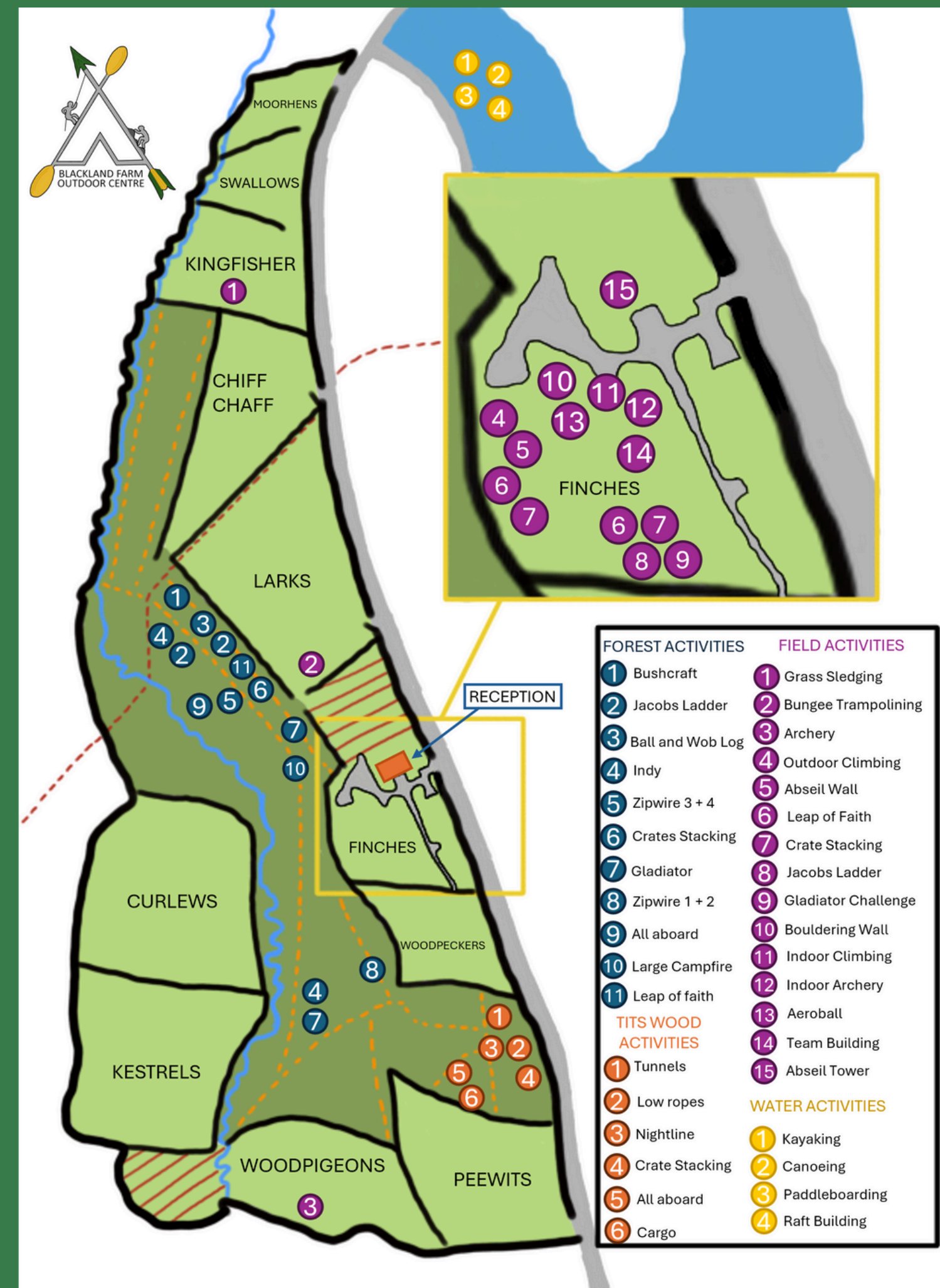
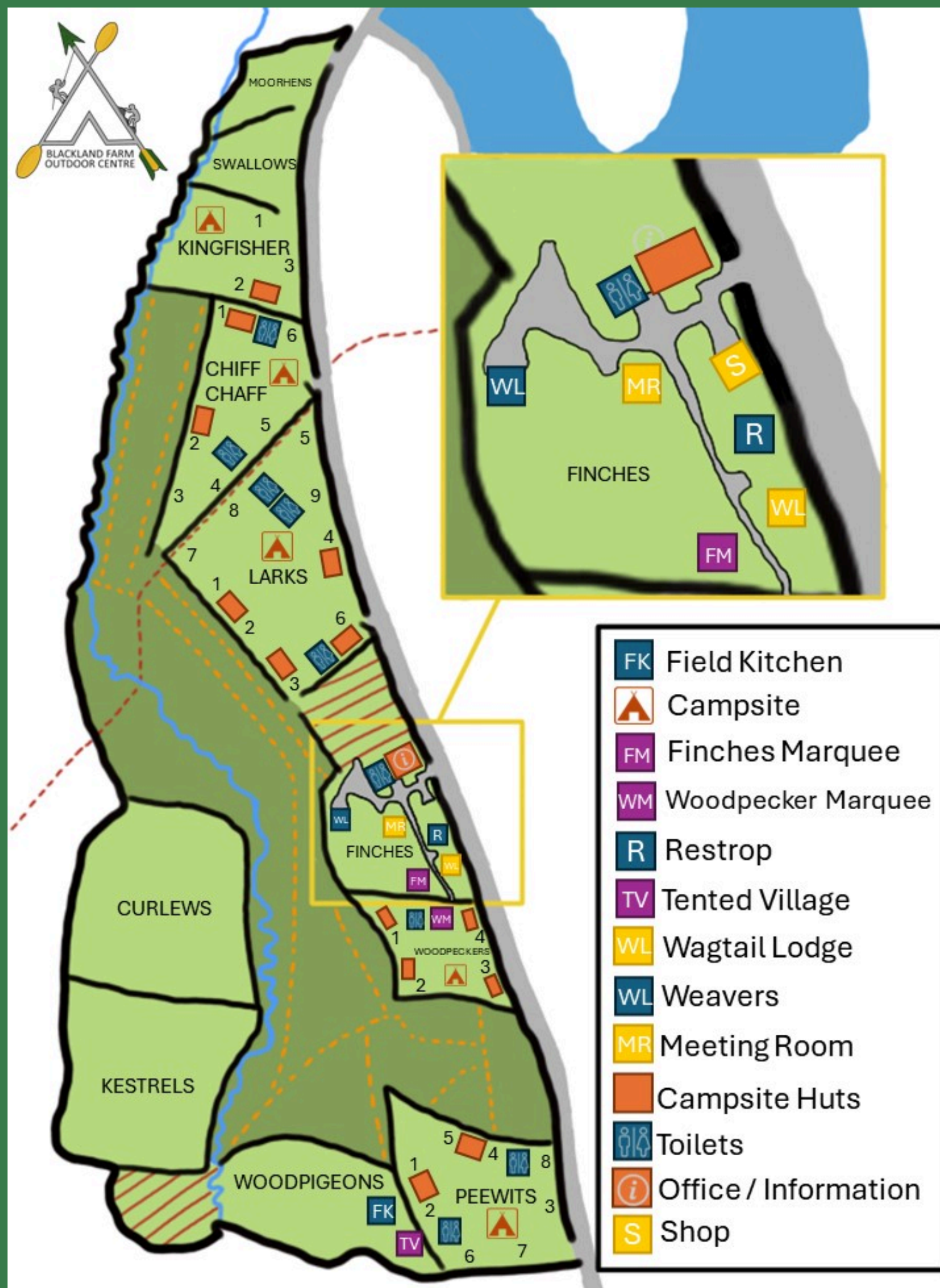

FOREST ACTIVITIES	FIELD ACTIVITIES
1 Bushcraft	1 Grass Sledging
2 Jacobs Ladder	2 Bungee Trampolining
3 Ball and Web Log	3 Archery
4 Indy	4 Outdoor Climbing
5 Zipwire 3 + 4	5 Abseil Wall
6 Crates Stacking	6 Leap of Faith
7 Gladiator	7 Crate Stacking
8 Zipwire 1 + 2	8 Jacobs Ladder
9 All aboard	9 Gladiator Challenge
10 Large Campfire	10 Bouldering Wall
11 Leap of faith	11 Indoor Climbing
	12 Indoor Archery
	13 Aeroball
	14 Team Building
	15 Abseil Tower
TITS WOOD ACTIVITIES	WATER ACTIVITIES
1 Tunnels	1 Kayaking
2 Low ropes	2 Canoeing
3 Nightline	3 Paddleboarding
4 Crate Stacking	4 Raft Building
5 All aboard	
6 Cargo	



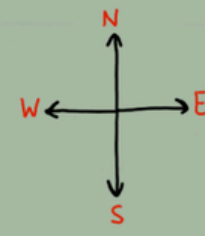

# BLACKLAND FARM OUTDOOR CENTRE



## FOREST ACTIVITIES

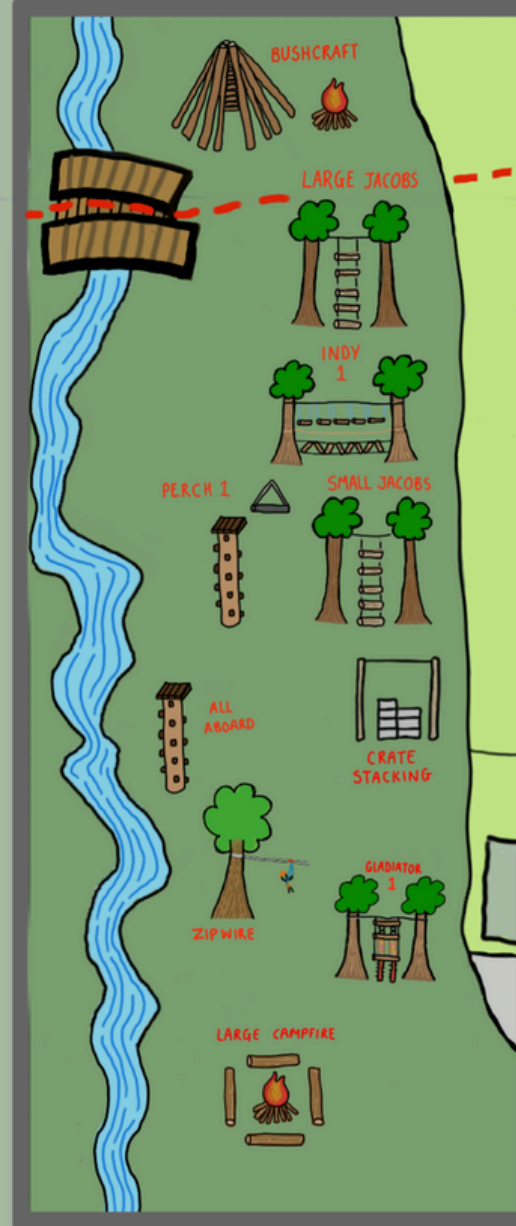

## TIT'S WOOD

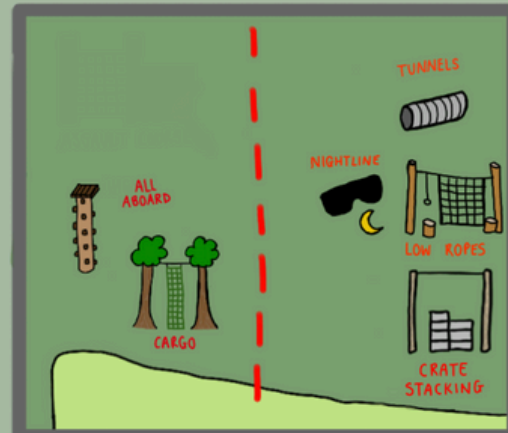

## KEY:



## FIELD ACTIVITIES

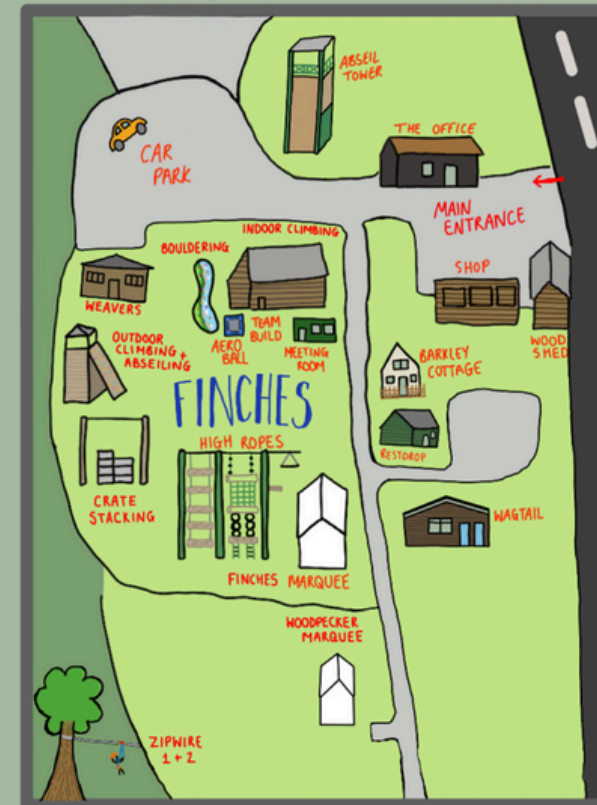

info@blacklandfarm.org  
Blackland Farm Outdoor Centre,  
Grinstead Lane,  
East Grinstead,  
West Sussex,  
RH19 4HP

JTiley<sub>24</sub>



Children will be split into three groups for activities. Each group will have a member of school staff in it.

All groups will complete the same activities on the same day (just in a different order).

# Land Based Activities



## Archery

A skill-building activity where participants use real bows and arrows to shoot at targets. Games included!



## Aero Ball

A physically challenging activity, which is a mixture between trampolining and basketball.

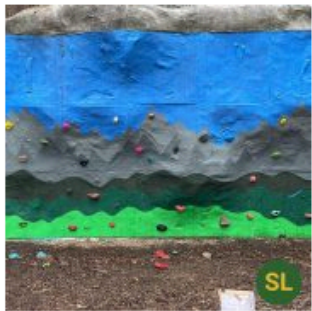

## Boulder Wall

A confidence building activity where participants work their way around the wall at a low height.



## Bungee Trampolines

A fun activity where participants are harnessed into a bungee cords, propelling them into the air as they jump.



## Bushcraft

A hands-on activity where participants get out in the great outdoors and learn essential skills for survival.



## Campfire

Toast marshmallows and engage in songs around the campfire in this traditional evening activity.



## Grass Sledges

Participants whizz down our hills on our specialist grass sledges- all of the fun without the snow!



## Nightline

Navigate on and off-site with torches in this immersive outdoor walk at night.



## Orienteering

Using a map navigate your way around our large site looking for markers. A real life treasure hunt



## Sucker Archery

Hire our sucker archery equipment to run a low-risk archery session with no less of the fun!



## Team Building

A team-based activity full of challenges and tasks to bring people together in achieving goals.



## Tunnels

Participants navigate through our artificial system of tubes to find the exit routes.



# High and Low Ropes



## Abseiling

A confidence building activity – participants abseil themselves from our 12 metre tower.



## All Aboard

A team-building High-Ropes activity where participants must work together to balance on a 'pizza box' at height.



## Ball And Wobbly Log

Participants must climb a ladder then traverse a wobbly bridge before climbing a tree and jumping for a ball! Can you reach it?



## Cargo Net

Participants race to the top of the giant Cargo Net. Who will win?



## Crate Stacking

A roped activity that builds teamwork and trust by working together to build a tower of crates for participants to stand on top of.



## Gladiator Challenge

Participants race up our vertical obstacle course or work as a team to get to the top as fast as possible. GLADIATOR READY!



## Indoor And Outdoor Climbing

Participants work together to safely belay participants up and down our climbing walls.



## Indy Bridge

Participants must climb trees and traverse the wobbly bridges to get to the top – Just like Indiana Jones!



## Jacobs Ladder

A team-based activity – participants must work together to climb to the top of a giant ladder, belayed by their friends.



## Leap Of Faith / Perch

A confidence building High Roped activity where participants must climb to a platform and then leap off to catch a trapeze bar!



## Low Ropes

Participants negotiate beams, wires and obstacles to reach the end of the course in a test of balance, trust, and coordination.



## Scrambling

Explore Stone Farm's hidden secrets. From traversing through gullies to discovering caves. It's all there to find!



## Zip Wires

Participants launch themselves from height onto our gravity defying zip lines!



# Water Activities



## Canoeing

Instructors work with participants to move single canoes around the water and participate in challenges to perfect their skills and explore the reservoir



## Improvised Raft Building

A water-based activity where participants build rafts and launch them on the water! Hopefully they hold together?!



## Kayaking

Participants learn how to paddle their own kayak and improve their skills with games and challenges.



## Mega SUP

Up to 12 Participants work together to paddle our 2 Mega SUPS around the reservoir and participate in games and challenges. Can YOU stay on board?



## Paddleboarding

Participants learn how to use Stand Up Paddleboards and improve their skills with challenges and games on the water!



## Rafted Canoes

Instructors work with participants to move rafted canoes around the water and participate in challenges and game to perfect their skills.

There will be one  
water activity.

# Blackland Farm 2026

Day 2	Group 1	Group 2	Group 3	Group 4
8.00am-9.00am	Breakfast			
9.00am-11.00am	Activity 4	Activity 4	Activity 4	Activity 4
11.00am-12.30pm	Lunch			
12.30pm-2.30pm	Activity 5	Activity 5	Activity 5	Activity 5
2.30pm-3.00pm	Break			
3.00pm-5.00pm	Activity 6	Activity 6	Activity 6	Activity 6
5.00pm-6.30pm	Dinner			
6.30pm-8.30pm	Evening Activity			
8.30pm-9.00pm	Goodnight and Bedtime			

Sample Timetable



# Blackland Farm 2026

- A Google Drive folder will be set up just for Year 6 residential photos. We did this for the first time during the previous Year 6 residential and it worked really well.
- Only Year 6 parents will be given access to the link.
- A few “token” photos will also be shared on social media.
- The Drive ensures you can see a wider range of photos without us needing to worry about permissions.
- We do ask that none of these photos are shared on your own personal social media accounts.

Photo Sharing

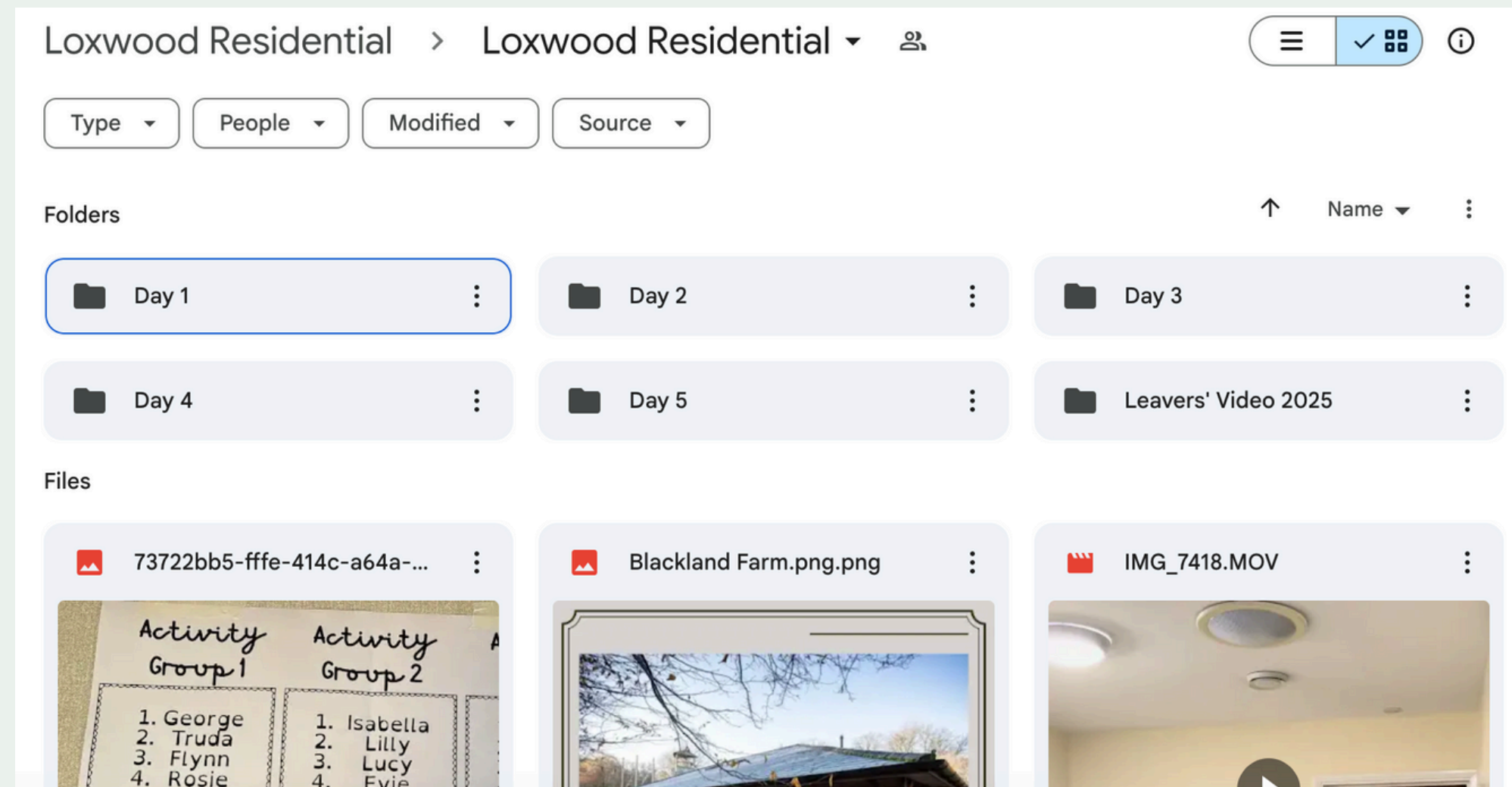





# Blackland Farm 2026

**Total cost**  
**£400**

**Deposit £40, then 9 monthly payments of £40**

Full balance to be paid by Friday 3<sup>rd</sup> April 2026

We must point out that under Government legislation all financial contributions for such trips are voluntary (except for the overnight expenses). Please do contact Mrs Mellors if payment creates personal problems. The School is dependent on these contributions in order to make the trip viable and we do reserve the right to cancel the trip and make alternative arrangements if it becomes financially unviable.



# 2026

During the Spring term, there will be another meeting where we will discuss the KS2 SATs and we will also have the opportunity to discuss the residential nearer the time.

## THANK YOU